

| REVISIONS | | | | | |
|-----------|-----|------------------------------------|-----------|----------|------|
| LTR | ECO | DESCRIPTION | DATE | APPROVED | ZONE |
| A | | INITIAL_RELEASE | 1/15/2016 | RWW | |
| B | | REV_TITLE_BLOCK_ADD_PULL_DIRECTION | 3/29/2016 | RWW | |

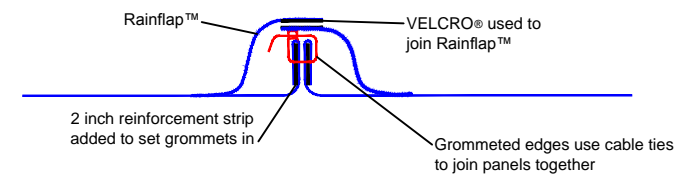
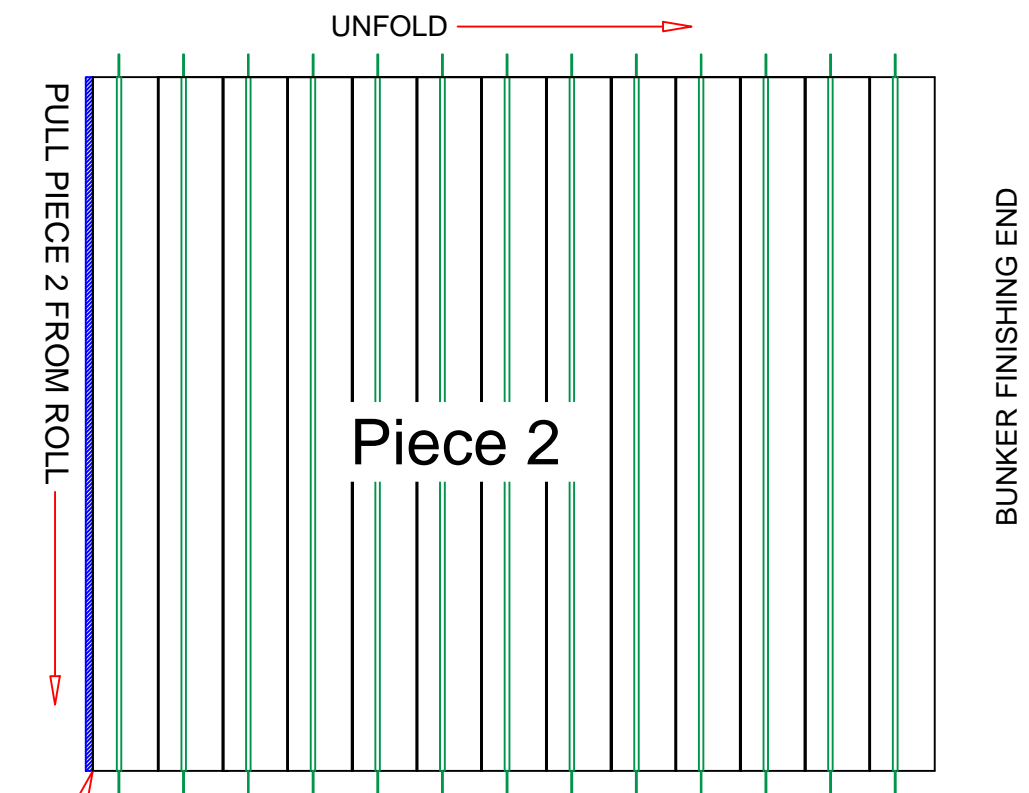
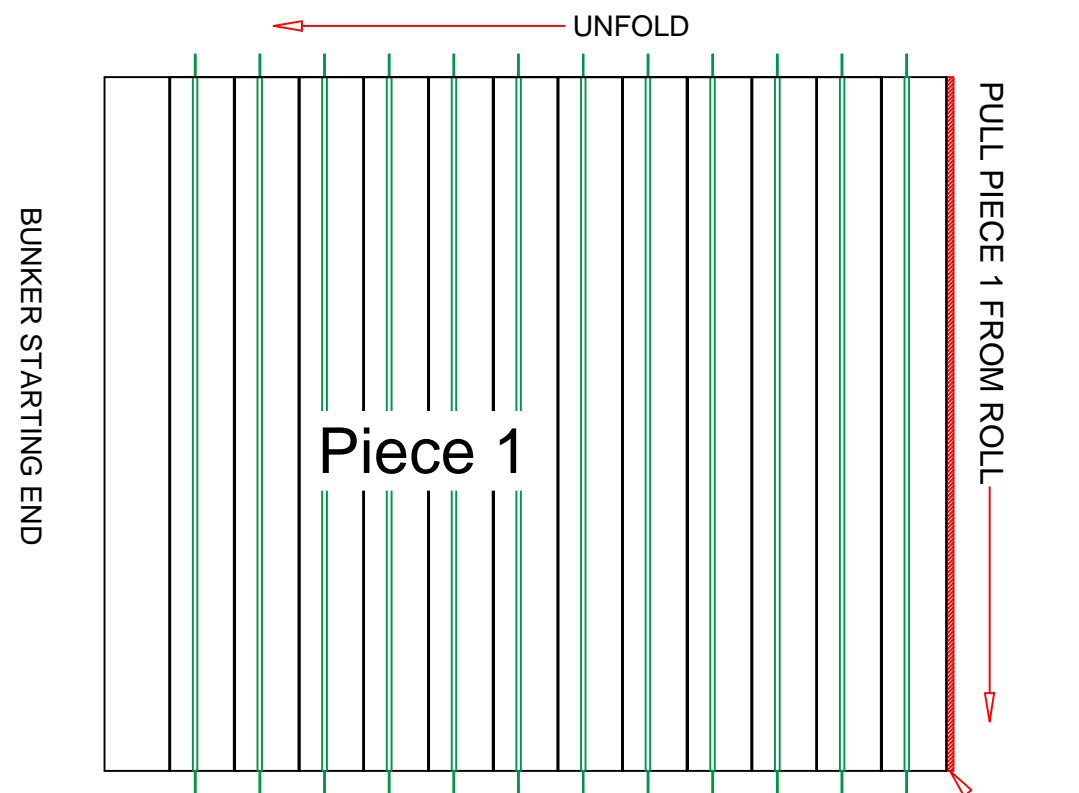
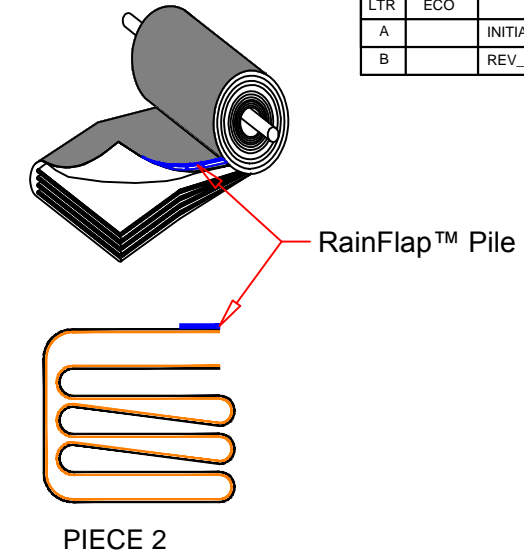
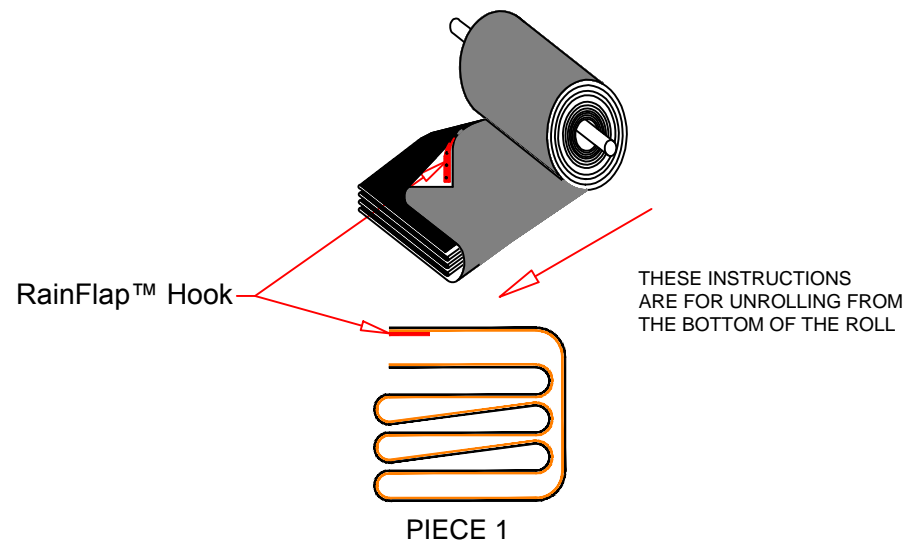

DEPLOYMENT INSTRUCTIONS:

1. PULL PIECE 1 & 2 ACROSS THE PILE AT ABOUT 1/2 OF THE LENGTH FROM THE STARTING END
2. FLIP TOP LAYER OF PIECE 1 OVER TOWARDS THE FINISHING END OF THE BUNKER, WHITE SIDE SHOULD BE UP
3. FLIP TOP LAYER OF PIECE 2 OVER AND PULL TOWARDS THE STARTING OF THE BUNKER
4. FASTEN RAINFLAPS™ OF BOTH PIECES
5. WHILE HOLDING PIECE 2 PULL PIECE 1 TO THE STARTING END OF THE BUNKER
6. UNFOLD PIECE 2 TO THE FINISHING END OF THE BUNKER
FOR FURTHER INSTRUCTIONS VISIT ravenefd.com/installation

| | | | | | |
|--|--|--|-------------|----------------|-----|
| | | COVER TYPE | | | |
| | | OVAL 2 PIECE with RainFlap™ and Straps Flip Fold | | | |
| RAVEN ENGINEERED FILMS PO BOX 5107 SIOUX FALLS, SD 57117-5107 +1 (800) 635-3456 | | SIZE | SALES ORDER | DRAWING NUMBER | REV |
| DRAWN: RWW DATE: 1/15/2016 | | B | 1 | O2RSFS | B |
| DO NOT SCALE DRAWING | | PROPRIETARY AND CONFIDENTIAL INFORMATION OF RAVEN INDUSTRIES INC. THIS DRAWING AND THE INFORMATION HEREON ARE RAVEN INDUSTRIES INC. PROPERTY AND MAY BE USED BY OTHERS ONLY AS AUTHORIZED IN WRITING BY RAVEN INDUSTRIES INC. - ALL RIGHTS RESERVED UNDER THE COPYRIGHT LAWS. | | | |